

000195. Perpetual Calendar



Material

- Paper/Cardstock – 4 kinds
- Cork tile (approx. 10 mm thick)
- Small clips – 4
- Glue or spray adhesive
- High-tack double-sided tape or adhesive
- Craft knife
- Ruler

(1) Cut out parts A through F. For A, two sets of each part will be cut out.

A-1

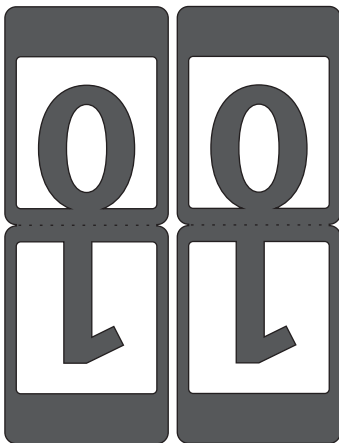

A-2

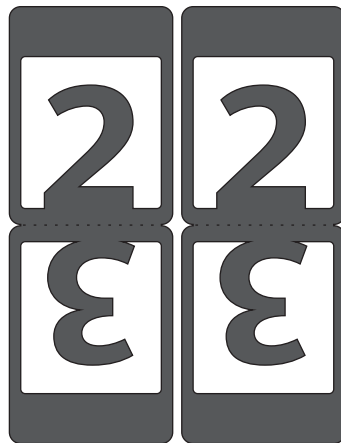

B-1



B-2



B-3

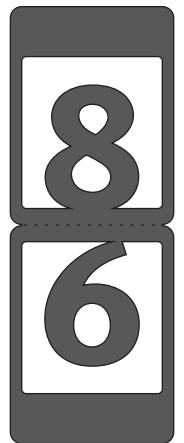

C-1



C-2



C-3



C-4



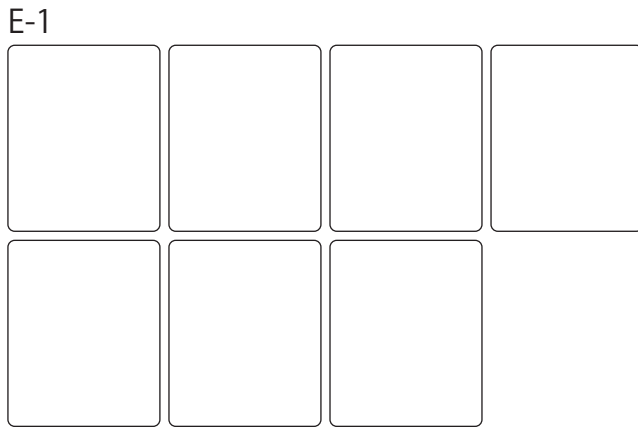
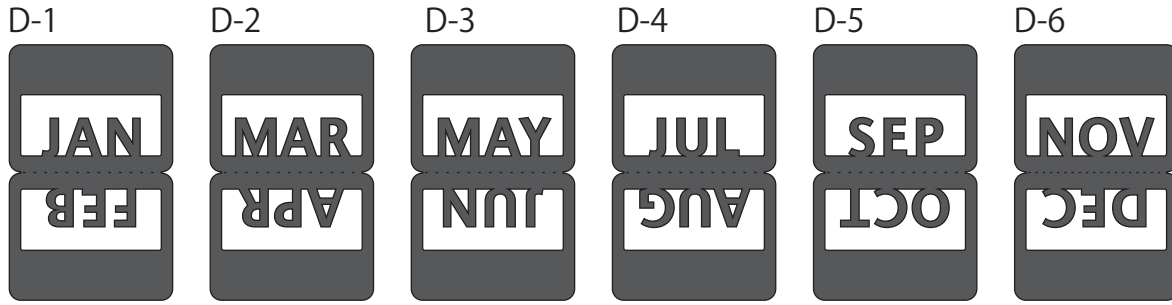

E-2
Today is

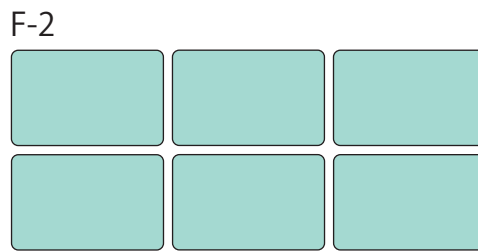
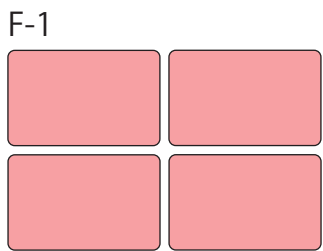

(2) Fold each A and B part along the dotted line, and then glue together the two halves with E-1 in between, as shown below.

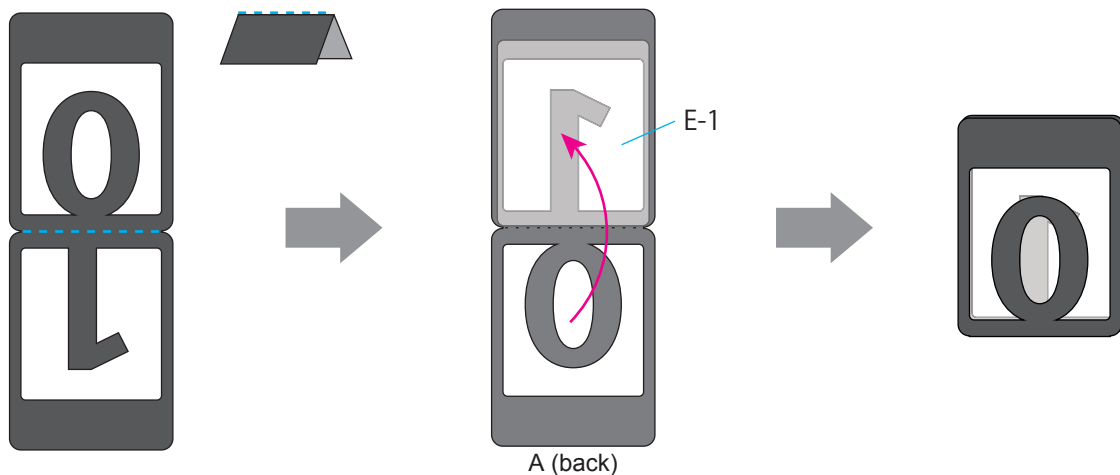

(3) In the same way, glue together the two halves of each C part with F-1 in between and the two halves of each D part with F-2 in between.

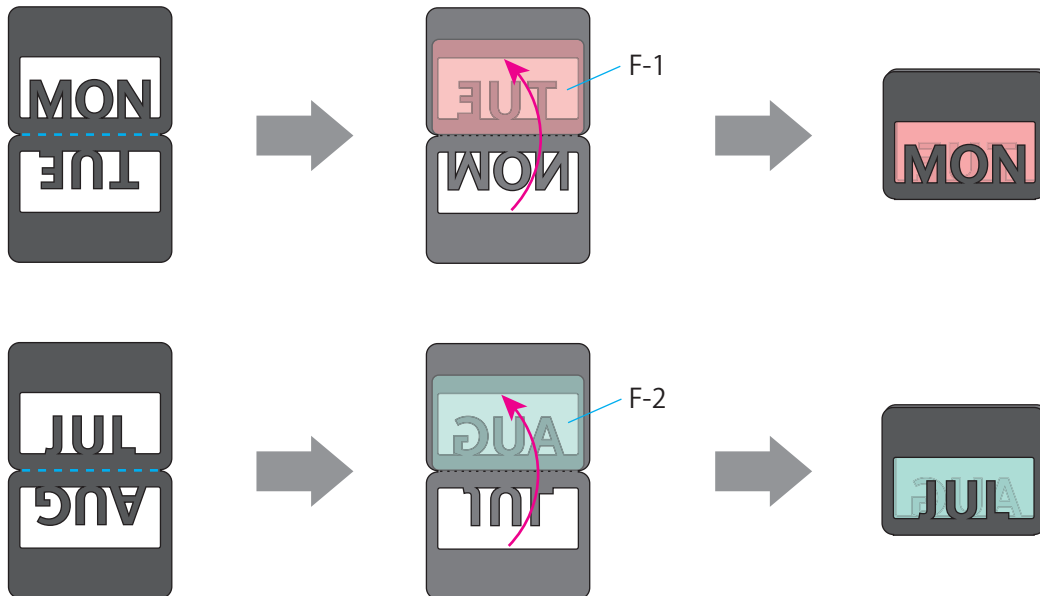

(4) With a craft knife, cut the cork tile to the dimensions in the layout diagram on the last page, and then glue on E-2.

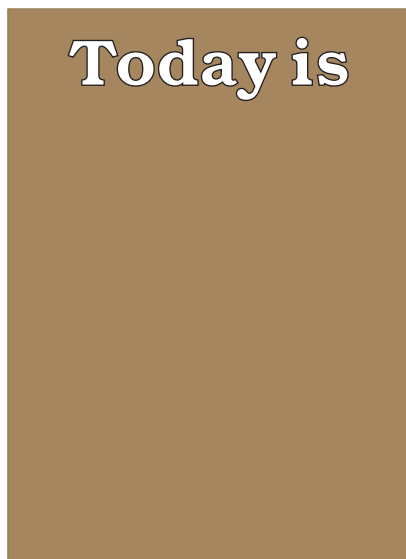

When gluing on the cut-out characters, use the leftover sheet as a template for accurate positioning.

(5) With double-sided tape or adhesive, attach the clips, and then clip on the pieces assembled in steps (2) and (3), as shown below.

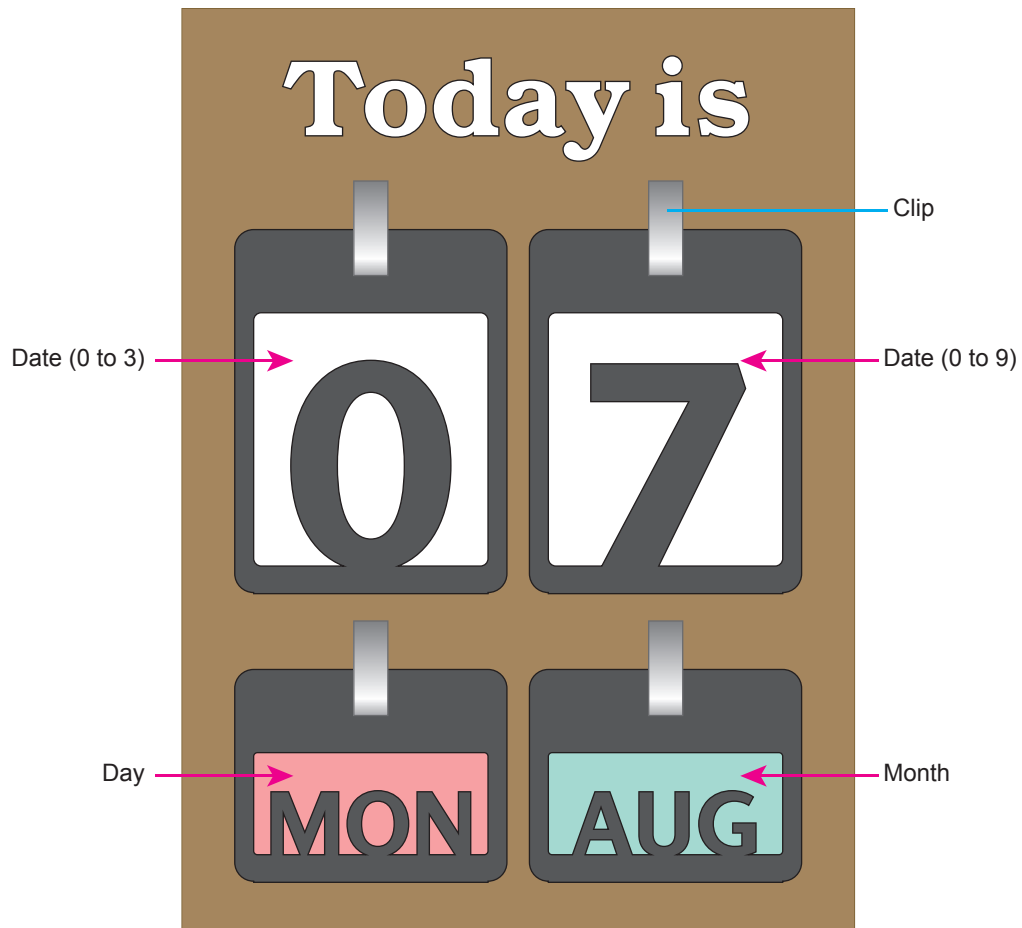

[Actual-size layout diagram]

