

# Important Addendum

We've recently improved the packaging of the Hemingworth thread cabinet to better protect it in transit. This has led to a last-minute modification to the instructions.

Before following the included instructions, you **may** need to screw the drawer runner guides onto the side panels.

1. Identify the left and right panels, and lay them out as below. They won't have the runners attached as shown in the photo, but will have pre-drilled holes showing their location.
2. Align the drawer runners over the pre-drilled holes as per the photo below, and screw them securely in place.

## Left Panel (L)

## Right Panel (R)

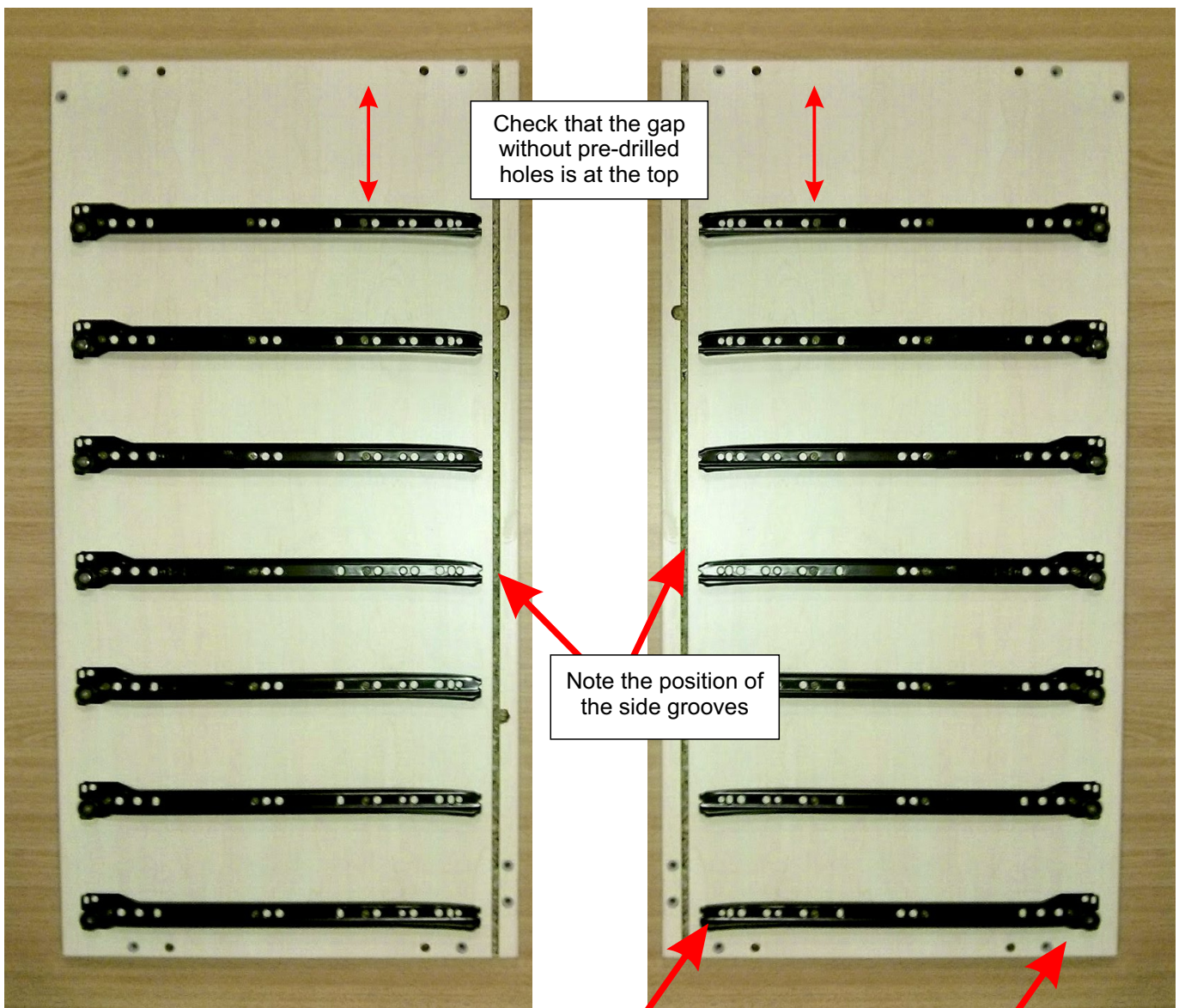

Check that the gap without pre-drilled holes is at the top

Note the position of the side grooves

The narrow end of the runners goes towards the groove.

The wheel is towards the bottom of the panel

---

# Inserting Twistlock Pins

---

It's important to insert the twistlock pins carefully to get a secure, solid assembly and avoid damaging your cabinet. Always use a hand screwdriver and never over-tighten.

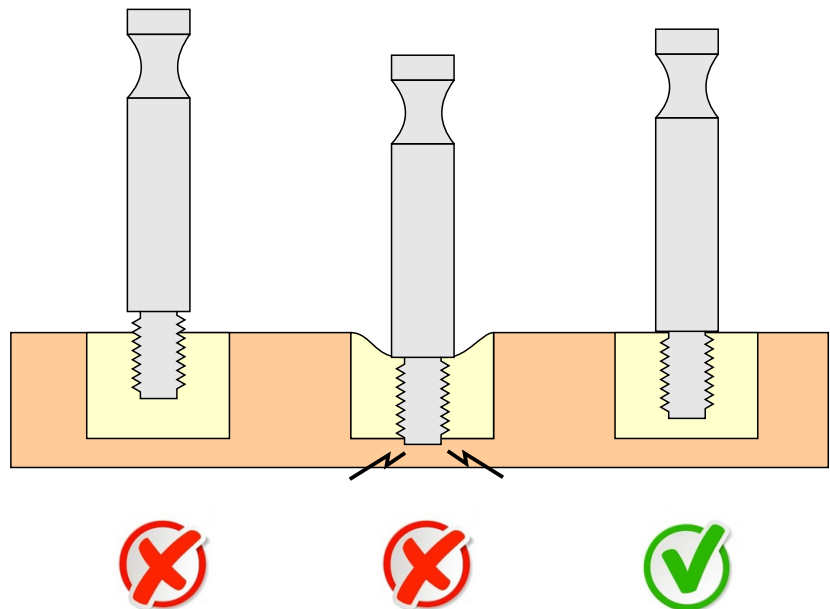
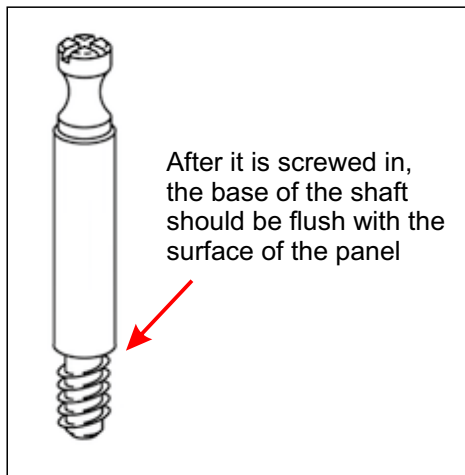

---

## Changes to Step 2

---

There has been a minor modification to the bottom panel (B).

The holes for the twistlocks are now on the opposite side of the panel to the groove. They still function in the same way, but are tightened from the outside of the cabinet instead of the inside. You may need to tip the completed cabinet on its side to reach these twistlocks.

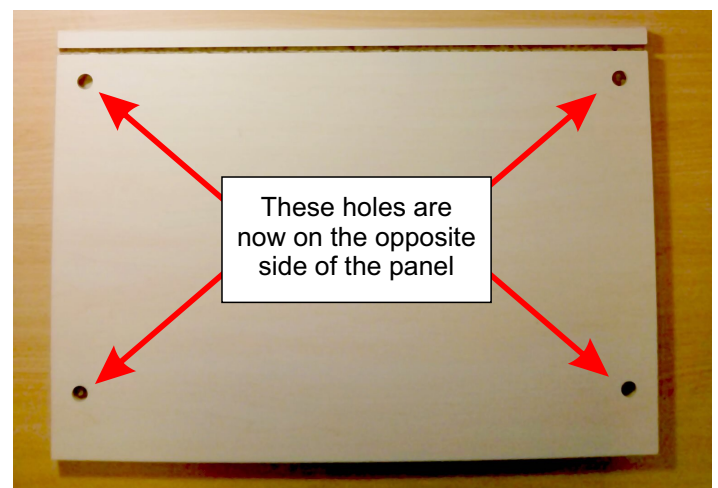



# Hemingworth Thread Cabinet Assembly Instructions

## Identifying the Parts

You may have spares of some parts.

Use the colour-coded arrows as a reference.



22x Twistlocks



Wall-Mount Plugs and Screws

Backing Joiner



The thread cabinet is packaged in two separate cartons. Depending on how the cabinet is delivered, both cartons may not necessarily arrive together.

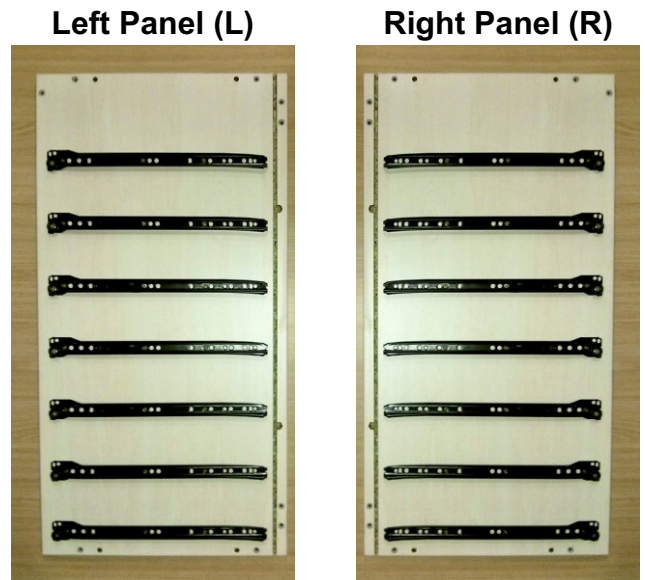
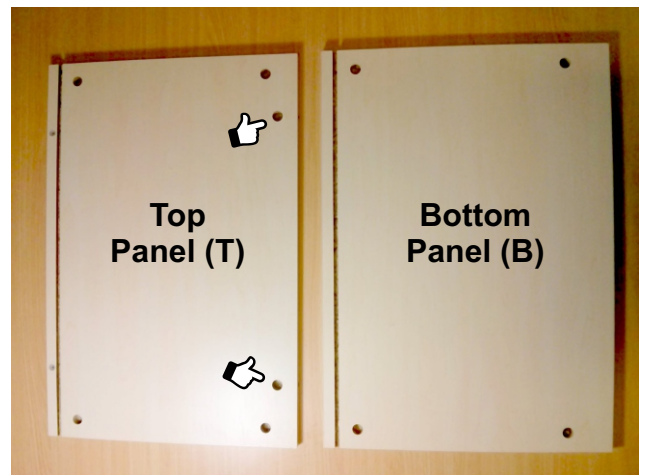

14x Drawer Runners

2x Backing Boards

Front Panel (F)

Wall Mount (W)

Back Support - Top (BT)

Back Support - Bottom (BB)



### You'll Also Need:

- Phillips head screwdriver
- Large flat-head screwdriver
- Drill with No. 2 Phillips bit (optional, recommended)



## Step 1: Assemble the Top

Lay out the Front (F), Top (T) and Back Support - Top (BT) panels.

Insert 4x Twistlocks and screw in 4x Pins as shown:

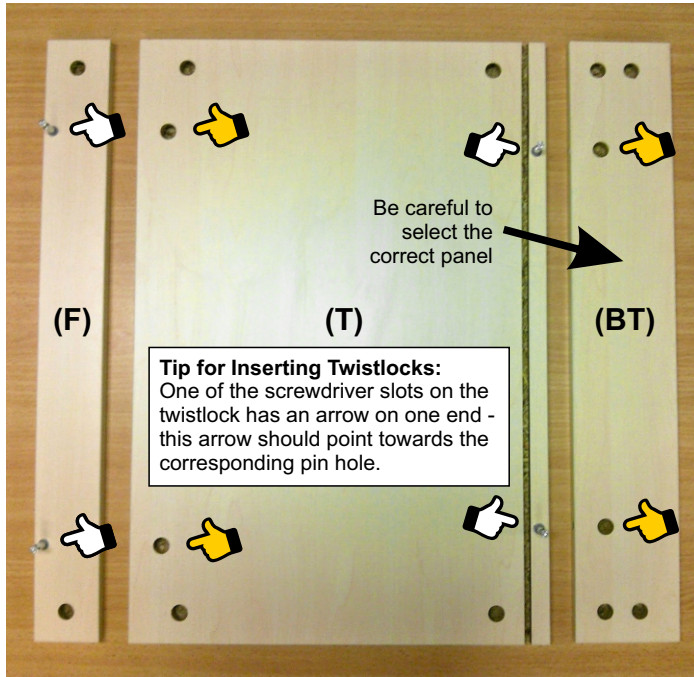

Join the three panels together, being careful to insert them the correct way around as shown below. Tighten all 4x Twistlocks securely using a large flat head screwdriver

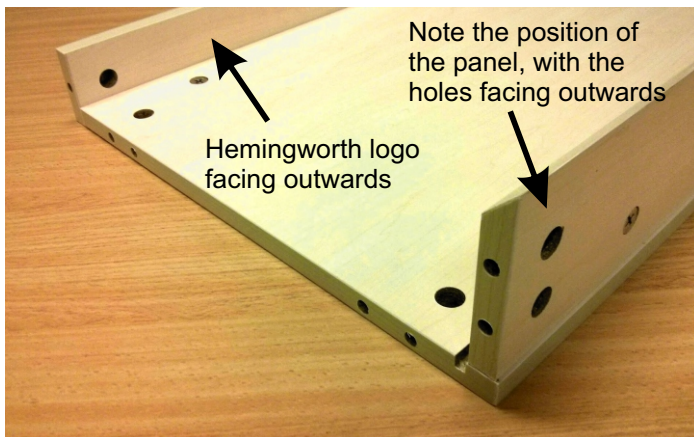

Insert 10x Twistlocks into the panels.

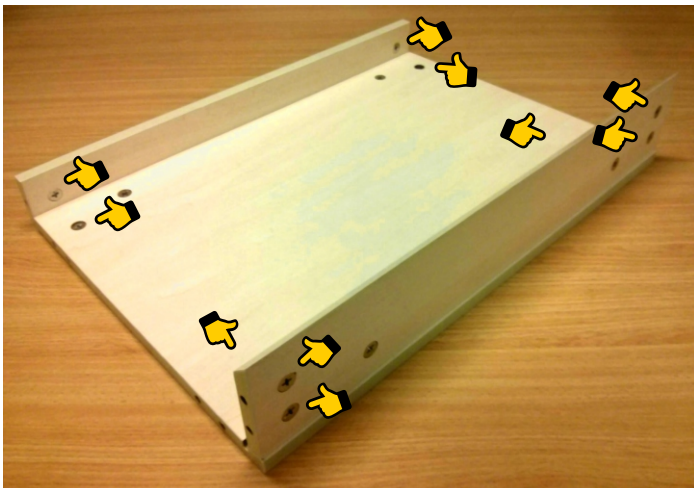

## Step 2: Prepare the Left Side

Set aside the top section just assembled. Lay out the Left (L) and Bottom (B) panels.

Insert 2x Small Clamps, 4x Dowels and screw in 9x Pins into the Left (L) panel as shown:



Insert 4x Twistlocks into the Bottom (B) panel:





### Step 3: Assemble the Left Side

Join the already-assembled top section with the Left (L) panel, being careful to connect it to the end shown below.

Tighten the 5x Twistlocks.

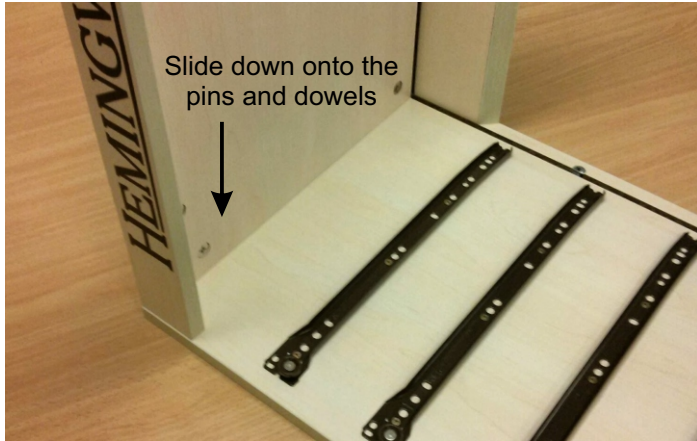

Join the Bottom (B) panel with the Left (L) panel. Tighten the 2x Twistlocks.

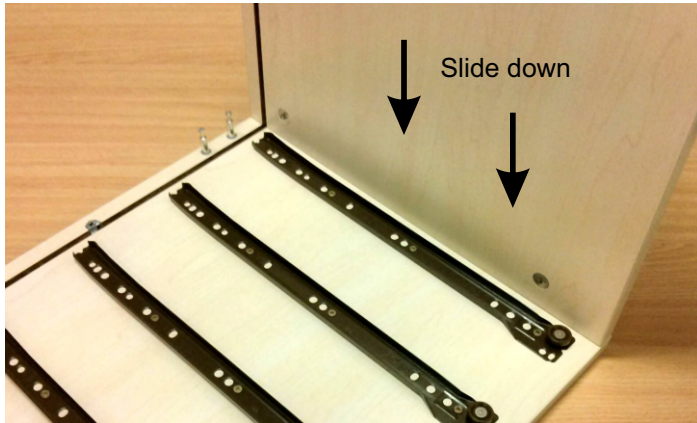

### Step 4: Add the Back Support

Insert 4x Twistlocks into the Back Support - Bottom (BB).



Slide the Back Support - Bottom (BB) panel onto the 2x pins near the Bottom (B) board, making sure the Twistlocks face outwards as shown below.

Tighten the 2x Twistlocks.

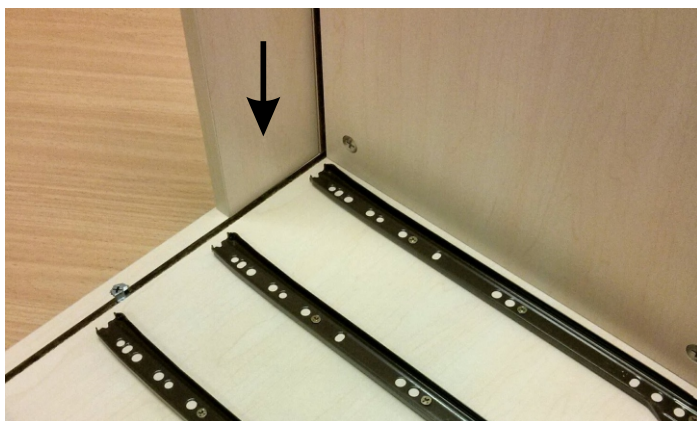

### Step 5: Slide in Backing Boards

Slide in one of the backing boards, making sure it sits evenly in the grooves. Push on the backing board joiner. This joiner may be a tight fit and need to be gently tapped into place. If using a hammer be careful not to damage the edges of the backing boards or joiner.

Slide in the second backing board. This may also need to be gently tapped into the joiner.

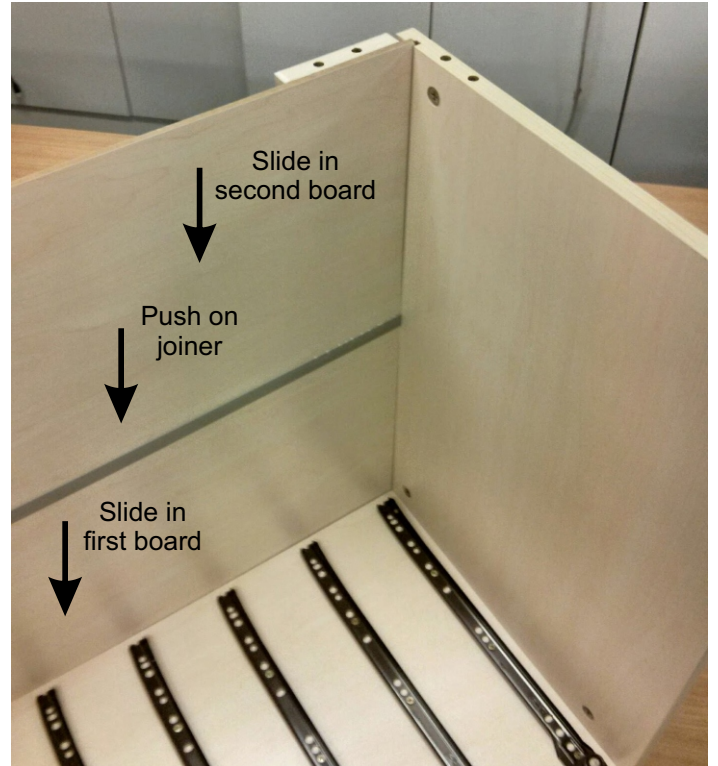

### Step 6: Assemble the Right Side

Lay down the Right (R) panel. As with the Left (L) panel previously, insert 2x Small Clamps, 4x Dowels and screw in 9x Pins.



Very carefully position the panel over the rest of the assembly. Align all of the dowels and pins, and gently tap the panel down into place. Make sure the backing boards are seated in the panel's groove.

Tighten the 5x Twistlocks inside the cabinet and the 4x Twistlocks on the back. Twist each of the 4x Small Clamps on the back of the cabinet so they are pressing into the backing boards.

Stand the cabinet up on its base. The Wall Mount (W) panel will still remain unused (see next page for details).



## Step 7: Assemble the Drawers

All 7 drawers in the carton are identical, but the assembly differs between the top 6 drawers and the bottom drawer. Set aside one drawer now as the bottom.

Affix two runners to each of the top 6 drawers as shown. Any three screw holes can be used to attach each runner, but avoid placing screws near the nails already in the panel. As the holes are not pre-drilled, using a drill or electric screwdriver is recommended. Ensure the runners are positioned firmly against the front and side of the drawer.

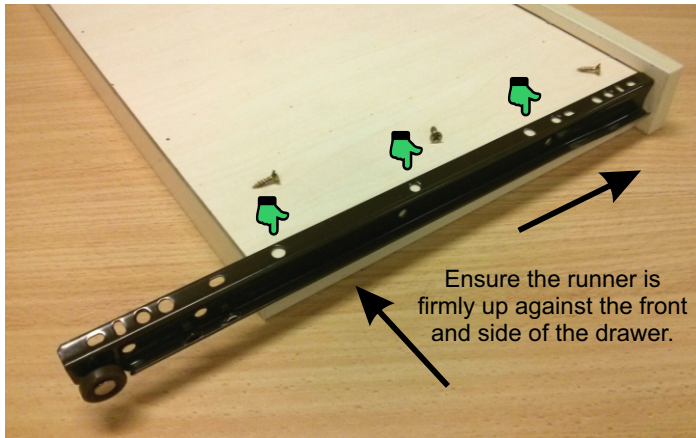

For the **bottom drawer only**, affix a spacer on both sides of the drawer before screwing in the runners. These spacers will lift the front of the runner about 5mm from the surface. Be careful not to over-tighten the screws and crush the spacer.

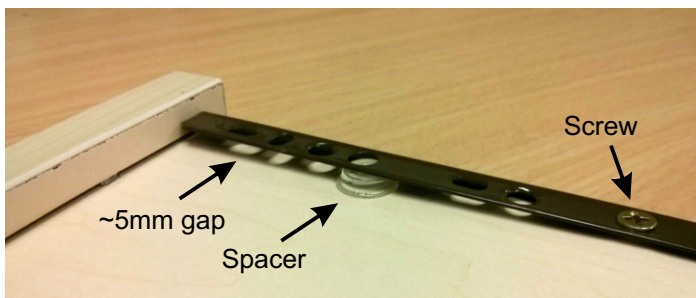
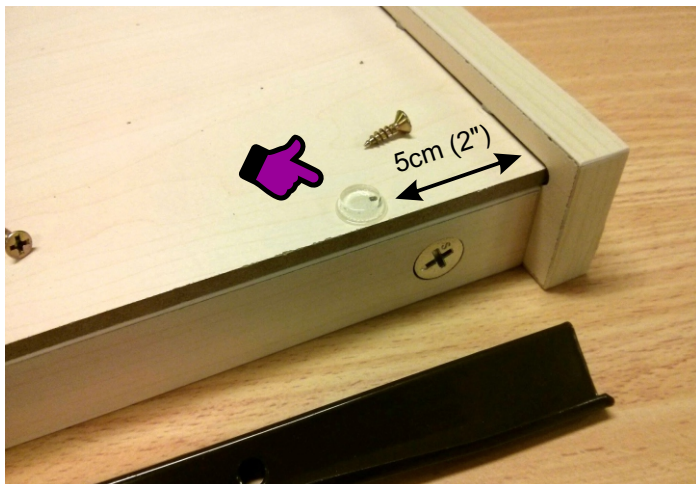

Insert all 7 finished drawers into the cabinet. If desired, apply the included stickers to the front face of each drawer to organise your Hemingworth threads. The stickers may need to be trimmed to size. Note that it is normal to have spare parts left over (dowels, screws, etc).

**Your cabinet is now complete!**

## Safety Information

**WARNING: If the thread cabinet is not mounted or anchored securely, it could topple forward and cause serious injury. Ensure it is fastened before use.**

For your safety, it is essential that the finished cabinet is securely anchored to a wall or sturdy desk before being filled with thread. Follow the appropriate mounting instructions below for your situation, or consult your local hardware store for alternatives.

### Wall Mounting

When full with thread the cabinet can weigh up to 45kg. It can be hung on a wall using the included wall mount panel. It is strongly recommended that wall mounting should only be attempted by an experienced tradesperson.

The Wall Mount (W) panel should be secured horizontally in the desired location, ensuring it is level and facing the wall as shown. It is essential that the panel is screwed firmly into the wall frame or an otherwise solid wall - plasterboard alone will not support the weight of the cabinet. *Note: the supplied wall plugs are for solid walls only and must not be used on plasterboard*

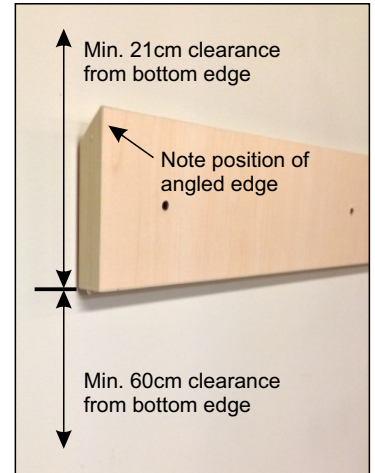

The cabinet can now be hung from the Wall Mount panel. For extra stability, the included safety bracket can be used to anchor the base of the stand to the wall.

### Desk Mounting

If the cabinet is placed on a desk, the included safety bracket should be used to attach it securely to either the desk surface or a wall behind the cabinet as shown.



### Stacking

Multiple thread cabinets are designed to be stacked together to create a larger storage unit. To stack two units, insert 4x dowels in the top of one cabinet and then carefully position the base of another cabinet over the top. Ensure both cabinets are independently affixed to a wall or desk - the stacking dowels are designed only to provide alignment, they will not prevent the cabinets from toppling.

Made in China

**Distributed by:**  
Echidna Sewing Products  
56 Neumann Road  
Capalaba QLD 4157  
AUSTRALIA



**Having problems? Call us on 1800 000 360.**